



CK COMPLETE KITCHENS
EST 1978

CARE
MAINTENANCE
&
WARRANTY





CARE MAINTENANCE & WARRANTY



Dear valued client,

Thank you for choosing **Complete Kitchens** to manufacture and install your new kitchen. We take great pride in our workmanship and hope that your new kitchen will bring you many years of happiness.

The following **Care, Maintenance and Warranty** details should cover most common on-going care details.

If you require further information or any more details not covered in this document, please do not hesitate to contact us.

Warmest Regards

Complete Kitchens Management



CARE FOR YOUR KITCHEN

We suggest you observe the following care processes & hints (as applicable) to keep your new kitchen looking bright and as new for many years to come.

DOORS & PANELS

LAMINATE

LAMINATE is a hardwearing material, but like all materials it can be damaged if used without the proper care and maintenance. The following information should help you to maintain the surface of laminate with the minimum of time and effort.

CLEANING INSTRUCTIONS

A wipe over with a clean soft damp cloth should be sufficient to keep all laminate surfaces clean. Soiled or light stains are removed with warm soapy water or with a common detergent, such as Mr. Muscle, Dissol, Nifty Solvent or bathroom cleaner, Flash Liquid, Bathroom Plus or Extra Strength Windex, containing no abrasive or no strongly acidic or alkaline ingredients.

It may be necessary to use a brush similar to a tooth or nail brush as well, where the surface is of a textured or embossed finish.



Wax or other polishes are unnecessary and should not be used on decorative laminates. If acrylic materials are used, avoid cleaning for 5 days after removal of the plastic protective film to allow the time for air curing.

WARNING: WHEN CLEANING, BE CAREFUL NOT TO RUB EXCESSIVELY. THIS MAY CAUSE A SHINE ON THE AREA.

THERMO-FORMED DOORS *(Vinyl Wrap)*

Vinyl wrap or thermo formed doors are a coated door that undergoes a heat vacuum process to wrap an MDF door substrate. They are low maintenance and can be easily cleaned using warm soapy water and a soft cloth or sponge (a toothbrush may be useful for hard to reach areas). Towel dry afterwards. Stubborn stains and marks (such as ball point ink) should be removed immediately by gently wiping the surface with mentholated spirits.

DO NOT use abrasives, solvent based or cream cleansers.

DO NOT allow hot objects to come into contact with the surface finishes.

THERMO-FORMED DOORS *(Vinyl Wrap)* cont:

Excessive heat, hot gases, steam and fumes produced by cooking appliances such as wall ovens, hotplates and dishwashers, can lead to damage to your thermo-formed doors and panels, such as delamination and discoloration.

To avoid such occurrences, the following precautions should be taken:

- Regularly check the condition and functions of the door seals around wall ovens and dishwashers so as to avoid leakage.
- Never allow heat, hot gases and fumes produced by wall ovens to come in to contact with cupboard doors and panels surrounding wall oven or appliances. It is recommended that (if possible) the wall oven be installed with a rear ducted exhaust. In the case of front panel exhaust, a heat deflector shield will need to be used.
- Always operate the Rangehood exhaust when using your bench top hot plates.

HIGH TEMPERATURES AND COOKING FUMES WILL CAUSE DAMAGE TO SURROUNDING CUPBOARD DOORS AND PANELS UNLESS AN EFFICIENT EXHAUST IS USED.



PIGMENTED DOORS *(Two Pack Paint)*

Two Pack finishes offer superior features such as:

- Hard wearing
- Longer lifespan
- Seamless edges
- Various gloss levels available from matt to full gloss

To care for your two pack doors, please clean up any spillages immediately.

DO NOT use abrasives, solvent-based or cream cleanser to clean your painted doors, these can have an adverse affect on the paint and cause bubbling or cracking. It's recommended to only use warm soapy water and a soft cloth.

Paint thinners can be used with extreme caution, but is not recommended.

Painted doors can be damaged by mechanical damage. Avoid contact with sharp and or hard objects, like cutlery, pots, pans and utensils.

SOLID TIMBER DOOR OR PANELS

Don't be alarmed if your timber doors move. Timber is a natural product that will absorb moisture and expand or contract. Excessive heat may cause shrinkage. The moisture content in your doors will, with time, vary in response to changes in the relative humidity of the air surrounding it.



SOLID TIMBER DOOR OR PANELS cont:

To help avoid this utilize your rangehood whilst cooking and open your doors and windows if you have evaporative air conditioning.

UV rays in sunlight can discolour timber doors. Red toned timber will turn more brown, whilst light timbers will gain a honey colour. There is no remedy for this occurring.

If you notice shrinkage, (which is a natural occurrence), within the centre panels, we suggest you purchase a bottle of Marveer, O'Cedar Oil, or Goddards Cabinet Makers Polish (all available from your local supermarket or hardware store).

Apply these polishes to the exposed timber area with a clean white rag. This will enhance and protect the timber surface.

To ensure that your surface finish remains in perfect condition the above polishes should be applied at three monthly intervals for the life of the product. Particular attention should be directed to the end grain areas of your doors or bench tops (as applicable).

CLEANING INSTRUCTIONS

The use of furniture polishes (in particular, ones which contain silicon) and waxes are not recommended for use on the timber surfaces.

Wipe with a warm damp cloth followed by a soft, dry cloth whenever spills occur.

Clean cooking grease off after cooking. Ensure handle area is wiped clean regularly.

Dust should be wiped from the surface with a clean, soft cloth in the direction of the grain as the fine dust particles can act as an abrasive.

Spilling of some materials as mentioned in "Staining" can affect the lacquer surfaces so the procedure of wiping spills as soon as they occur will help avoid damage to the timber surfaces.





BENCH TOPS

FABRICATED STONE BENCH TOPS

(Engineered Stone, Marble & Granite)

Steel supports have been incorporated in opening apertures of your sink, hotplates, dishwashers etc. However, because of the reduced amount of stone left, the area immediately surrounding these areas are more vulnerable to accidental damage and/or abuse.

In general, **DO NOT** under any circumstance sit or stand on Stone Bench Tops. They are **NOT** unbreakable.

ENGINEERED STONE *(Quartz Stone)*

The most common type of stone bench top is engineered stone which are generally 91%-95% quartz based, brands such as **Caesarstone®** and **Consentino**.

Caesarstone® has outstanding properties that ensure ease of maintenance and longevity. They will withstand exposure to tea, soda, wine, vinegar, lemon juice and strongly colored spices but can be permanently damaged by exposure to strong chemicals and solvents. **DO NOT** use products that contain trichlorethane or methylene chloride, such as paint removers or strippers. Avoid any highly aggressive cleaning agents like oven cleaner that have high alkaline/h levels. Should the surface be accidentally to any of these damaging agents, rinse immediately with water to neutralize the effect.

EVERYDAY CLEANING

Caesarstone® requires very little maintenance to keep the surface looking like new. For everyday, routine cleaning of **Caesarstone®** we recommend wiping the surface with warm soapy water (a mild detergent) and a damp cloth or alternatively use a quality spray and wipe type cleaner if you wish to give a thorough clean. Cream Gumption, Jif or Powder Ajax with a plastic scourer can be used without damaging the stone.

Bleach and acetone can also be used if required to remove stubborn marks. To remove adhered materials like food, gum, nail polish, first scrape away the excess with a sharp blade. If there are any grey metal marks on the surface, one of the regular cleaning agents will remove it.



HEAT RESISTANCE

Caesarstone® will tolerate brief exposures to moderately hot temperatures, however prolonged contact with very hot pots, pans, electric frying pans and oven trays directly from the hotplate or out of an oven onto the surface of **Caesarstone®**. We always recommend the use of a hot pad or trivet to place hot items onto.

POLISHING

As **Caesarstone®** is non-porous, it will therefore keep its lustrous gloss and ultra smooth surface without polishing. And it never needs sealing.

MARBLE BENCH TOPS

Marble is a soft porous natural stone. Variation in colour, grain, structure and veining is to be expected. Small holes, pot marks, fine cracks, and imperfections are common in many marble colours and are unavoidable. Different Marble comes in varying slab sizes and as such joins in bench tops may be frequent.

Marble can be scratched and stained easily and with almost any household items.

It cracks easily if abused or misused and is only recommended if very little abuse is likely.

In cases where the surface has been stained, scratched or cracked there is little chance of satisfactory rectification.

CLEANING

To keep a marble surface clean, mild soap and warm water should be used. Avoid any kind of chemical cleaning products.

Use clear car wax to refresh marble surface.

MAINTENANCE TIPS

For the removal of fresh stains on a marble surface pure methylated spirits or pure chlorine can be used. (Put methylated spirits or chlorine on a clean white cloth and leave it on the stain for at least 24 hours). Repeat this process as many times as required to dissolve the stain.

PLEASE NOTE: CHLORINE ON POLISHED MARBLE SURFACES MAY CREATE DULL SPOTS.

GRANITE BENCH TOPS

Granite is a hard but porous stone. Variation in colour, grain, structure and veining is to be expected. Small holes, pot marks, fine cracks, and imperfections are common in many granite colours and are unavoidable. Different granites come in varying slab sizes and as such joins in bench tops may be unavoidable.

Granite might stain if it comes in contact with many household items. Particular care should be taken with hot oil.

Granite might scratch if it comes in contact with another stone, (especially granite and diamonds).

Granite might crack if it comes in contact with extremely hot items and if it is abused or misused.

CLEANING

To keep a Granite surface clean, mild soap and warm water should be used. Avoid any kind of chemical cleaning products.

Use clear car wax to refresh granite surface.

MAINTENANCE TIPS

In the event of accidental damage or abuse by scratching or cracking there is very little that can be done to rectify the surface.





LAMINATE BENCH TOPS

Laminate Bench tops are produced by a variety of manufactures, care and maintenance for all laminate bench tops is similar.

GENERAL CARE

- Avoid scourers and abrasives as they will damage the surface.
- Don't place hot appliances or objects from oven or cooker onto a laminate surface.
- Don't cut on the laminate surface.
- Keep waxes and polishes well away as they dull the natural shine.
- Do not use strong acidic, alkaline or bleach for normal cleaning as these might etch the surface.

STREAKS

Streaky marks sometimes show on dark colours after cleaning. An all-purpose cleaner such as Windex spray cleaner or Ajax Spray n Wipe usually removes these.

GREASE

Using a mild dishwashing detergent in water will remove greasy marks. Dab, wait and wipe away. Finish with an all-purpose cleaner such as Windex spray cleaner or Ajax Spray n Wipe.

SPILLS

Laminate surfaces resist staining from most household chemicals. With some accidental spills however, prompt action is essential. Wipe off beetroot, grape and berry juices, first aid preparations, concentrated bleach, oven cleaners, dishwasher detergents, artificial dyes, hair colouring and solvent based pen ink immediately. Specialty glues such as Super Glue must also be removed straight away with acetone (nail polish remover).



STAINS

If the stain won't budge with Extra Strength Windex, try methylated spirits or dab the stain with a diluted bleach mixture (1 part bleach to 8 parts water); leave for 3 minutes then wash off with water and dry. Finish off with Extra Strength Windex. Only as a last resort if a stain persists try 2 or 3 rubs with a crème cleanser or white toothpaste, wash and dry. Please note that bleach or these abrasive cleaners may irreversibly damage the laminate surface.

SCRATCHES

Laminate surfaces will withstand normal wear and tear, but can be damaged by scratching or cutting with utensils, knives and unglazed pottery. Darker colours will show scratches more readily than lighter colours. In general, dark colours and high gloss surfaces require more care and maintenance than lighter colours or lower gloss colours. To minimise scratching, always place and lift objects from the surface – never drag or slide them across the surface.



SPECIFIC CARE

(This applies to Squareform Benchtops, Fire Retardant Laminates, Chemical Resistant Laminates, Aquapanel Wet Area Paneling, Vizage Wall Lining, Fusion Laminates and Compact Laminate)

A damp cloth will remove spills and greasy spots. Rub with a clean dry cloth to bring back brightness. Occasionally clean with mild dishwashing detergent. To remove heavy build-up of dirt use cleaners such as Mr. Muscle, Windex or Ajax Spray n Wipe spray cleaners.

DIAMOND GLOSS LAMINATES

Wipe off spills or marks promptly with gentle rubbing using a soft cloth and mild dishwashing detergent. Dry with a soft, dry cloth. For more persistent marks, use a glass window cleaner. Never use abrasive cleaners – even those in liquid form – as they will mark the high gloss surface.

METALLIC LAMINATES

(Innovations)

Wipe off spills or marks promptly with a soft cloth and mild dishwashing detergent. Dry with a soft, dry cloth. For more persistent marks, use a glass window cleaner. Never use abrasive cleaners – even those in liquid form – as they will mark the surface. Also never use solvents on metallic laminates or acids or alkalis.

STAINLESS STEEL LAMINATES

(Innovations)

Wipe off spills or marks promptly with a soft cloth and mild dishwashing detergent. Dry with a soft, dry cloth. For more persistent marks, use a glass window cleaner or methylated spirits. Never use abrasive cleaners – even those in liquid form – as they will mark the surface. Specialty stainless steel cleaner can also be used if necessary.

BENCH TOPS – CORIAN®

Corian® is the original solid surface material made only by **DuPont**. By nature, **Corian®** is easy to clean, easy to care for and easy to live with. With proper care, **Corian®** can remain as beautiful and elegant as the day it was installed. However, **Corian®** is unlike any other material and there is a unique way to look after it.

The following guidelines will help to ensure your **Corian®** surface continues to perform for many years to come.



PREVENTING TIPS

Although **Corian®** is quite resistant to heat, you should always use a hot pad or a trivet with rubber feet to protect **Corian®**.

Hot pans, as well as some heat-generating appliances like frying pans or electric cooking pots, can damage the surface if a hot pad or trivet is not used.

In most cases, **Corian®** can be repaired if it is accidentally damaged. However, be sure to follow these guidelines to prevent any permanent damage to **Corian®**.

- Avoid exposing **Corian®** to strong chemicals, such as paint removers, oven cleaners, etc. If contact occurs, quickly flush the surface with water.
- Remove nail polish with a non-acetone-based polish remover and flush with water.
- **DO NOT** cut directly on **Corian®** countertops.



SIMPLE CLEAN

As a general rule, when caring for **Corian®** always start with a Simple Clean. Avoid using abrasive scouring pads for routine cleaning.

After food preparation and cooking simply wipe your **Corian®** surface with a damp sponge or cloth. Thanks to the non-porosity of **Corian®**, this will hygienically clean your **Corian®** surface.

Use soapy water or an ammonia-based cleaner along with a damp sponge or cloth. Rinse clean.

Wipe your surface with a damp sponge or cloth and towel dry. Hard water leaves visible water marks on **Corian®**, just as on glassware, which is why it should be wiped dry with a soft cloth. If marks persist, try the method outlined under Deep Clean – Stubborn Stains.

DEEP CLEAN

- STUBBORN STAINS

For more stubborn stains you will need to occasionally give your **Corian®** surface a more thorough clean and refresh using a mild abrasive cleanser like **Gumption®** paste cleanser, Jif Cream Cleanser or Ajax cream or powder cleanser.

Firmly wipe your **Corian®** surface with either a non scratch Scotch-Brite pad or a damp cloth, using a wide circular motion. Always finish by rinsing and wiping your surface with a damp cloth or sponge. The **Vileda®** range of cloths and non-scratch scourers are recommended by **Corian®**.

- LIGHT MARKS & SCUFFS

Most light marks and scuffs may be removed by wiping your surface firmly with a damp sponge or cloth and a mild abrasive cleanser. However, if this technique fails to work, please contact **Corian® Customer Service Centre** on **1800 267 426** to personally discuss other care alternatives.



DOOR HINGES - ADJUSTMENTS

See below the instructions of how to adjust your hinges.

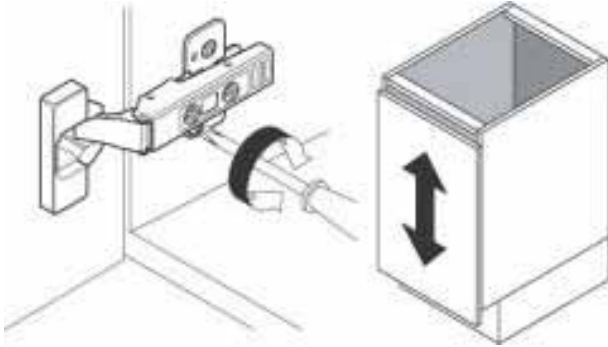

HEIGHT ADJUSTMENT

This adjustment involves two screws, one to the top and one to the bottom of the clip. Loosen the screws slightly and then lift or lower the door until it is in the position you want. Re-tighten the screws to secure the door.

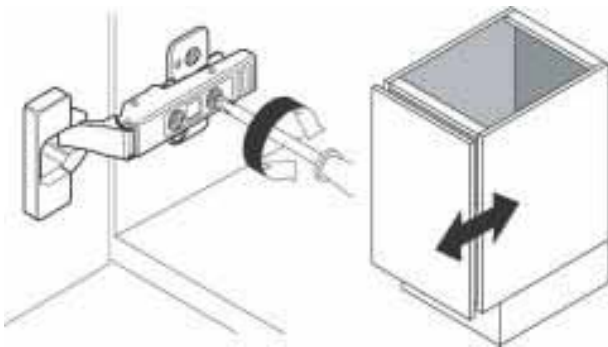

DEPTH ADJUSTMENT

Use this screw to adjust how far out or in the doors are in comparison to your cabinet and to the other cabinet doors and drawers surrounding it. Loosen the screw and manually push or pull the door to adjust it. Re-tighten the screw when the door is in the position you want.

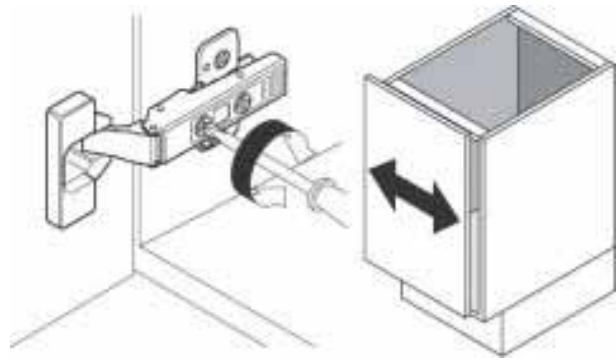

SIDE TO SIDE ADJUSTMENT

Using a Phillips head screwdriver, turn the adjustment screw clockwise and counter clockwise to move the door--the direction of turn and its effect is dependent on which the side of the door the hinge is attached.

On a door with a **RIGHT SIDE HINGE**:

- Turn the screw **CLOCKWISE** to move the door to the **RIGHT**
- Turn the screw **COUNTERCLOCKWISE** to move the door to the **LEFT**

On a door with a **LEFT SIDE HINGE**:

- Turn the screw **CLOCKWISE** to move the door to the **LEFT**
- Turn the screw **COUNTERCLOCKWISE** to move the door to the **RIGHT**

Complete Kitchens can organise for one of our qualified tradesman to make the adjustments for you, however there is a charge for this service.

Please contact us for further information.

PLEASE READ ABOVE PRIOR TO USING YOUR NEW CABINETS. FAILURE TO COMPLY MAY VOID YOUR WARRANTY.

COMPLETE KITCHENS WARRANTY TERMS & CONDITIONS



Subject to the terms and conditions set out in this warranty **Complete Kitchens** warrants to the original purchaser for interior residential use that we will repair or replace any cabinet carcass that suffers a failure in its structural integrity as a result of materials or manufacturing defect without charge within 10 years from date of installation. Failure of structural integrity means the carcass breaking or cracking under normal domestic use.

The warranty period for our cabinets, doors, bench top and internal fittings against defective materials or faulty workmanship is subject to manufacturer limited warranty. We specify Hettich or Blum hardware for our kitchens who offers a Lifetime warranty on all drawer runners, hinges and drawers. This guarantee is in addition to all other statutory warranties which usually apply.

THIS WARRANTY DOES NOT COVER THE FOLLOWING CIRCUMSTANCES:

- If the house shifts, and the cabinets go out of level;
- Any natural occurrence or other circumstances not within the control of **Complete Kitchens** such as flood, fire, water damage;
- Alteration of any part of kitchen or cabinets by any person other than someone employed by or subcontracted by **Complete Kitchens**;
- Shrinkage of panels and joints are normal;
- If you have conducted your own installation, any damage to the cabinets due to faulty or incorrect installation;
- Any damage caused to the cabinets if you are arranging your own delivery rather than using **Complete Kitchens'** delivery service;
- Natural fading or damage due to direct or indirect exposure to sunlight or other;
- Any cabinetry less than **\$5,500** including gst in value;
- Failure on the part of the buyer to follow any instructions or guidelines; provided by **Complete Kitchens**;
- Reasonable wear and tear;

Continued on next page...



- Handles and knobs;
Accessories;
Appliances;
Acrylic Benchtops; and
Sinks & Taps.
- Physical abuse, misuse, accidents, exposure to excessive heat, exposure to excessive moisture, exposure to excessive weight placed in, on, surrounding or attached to product, the use of solvents, abrasives, unsuitable cleaning agents or corrosives, improper maintenance, normal 'wear and tear', scratches, scuffs, burns, stains, wipe marks on darker colour or glossy or smoother surfaces;
- Insect or vermin infestation;
- Outdoor kitchens, the warranties only apply to indoor kitchens;
- The Guarantees are not transferable, including to subsequent property; owners.
- All warranty claim must be made in writing; we will email you a form to fill in which you will need to attach your receipt as proof of purchase.

COMPLETE KITCHENS

RESERVES THE RIGHT FOR THE PRODUCT TO BE INSPECTED BY AN AUTHORISED REPRESENTATIVE PRIOR TO ANY CLAIM BEING PROCESSED. IF THE REPRESENTATIVE FINDS THAT THE ITEM IS NOT UNDER WARRANTY THEN A CALL OUT FEE WILL APPLY.

IF A PRODUCT IS NO LONGER AVAILABLE AND CANNOT BE REPAIRED, COMPLETE KITCHENS WILL, IN ITS ABSOLUTE DISCRETION, REPLACE THE PRODUCT WITH A SUBSTITUTE ITEM.

PLEASE NOTE:

FOR ALL WARRANTY RELATED REPLACEMENTS, **COMPLETE KITCHENS** HAS AN HOURLY RATE OF \$90 PLUS GST TO RE-HINGE, DRILL AND OR INSTALL A DOOR, PANEL OR FRAME.

PLEASE RETAIN THIS WARRANTY CERTIFICATE WITH YOUR PURCHASE RECEIPT AS THIS WILL BE REQUIRED WHEN CLAIMING SERVICE UNDER THIS WARRANTY.

SPECIFIC PRODUCT WARRANTIES

Complete Kitchens only work with well known and respected brands to ensure we provide you the best quality and service.

Hence we are able to extend specific warranties on different materials & products.

Separate details can be found through the following links:

The Polytec logo is displayed in a black, lowercase, sans-serif font within a thin black rectangular border.

POLYTEC DOORS & BENCHTOPS

Subject to the conditions and limitations set out in the warranty, the products supplied to you will, under normal use be free from defects arising from manufacture of the product, the warranty period for the products supplied is 7 years.

In the event that a claim is made and it is established to Polytec's satisfaction that there is a manufacturing defect in the product in breach of the warranty in clause 1, then Polytec will, at its option, either repair the product at polytec's premises or on site (as elected by Polytec) or provide replacement product (in a manner polytec considers reasonable).

This warranty does not extend to fair wear and tear, delamination or any damage, defects or failures within the product which (in Polytec's opinion) directly or indirectly arise from on-site use.

For full warranty terms and conditions on the Polytec Benchtops and Doors [read here](#).



LAMINEX DECORATIVE SURFACES

Laminex Vertiboard
Doors Warranty

VIEW PDF

Laminex Silk
Finish Warranty

VIEW PDF

Laminex Lamiwood
MR Warranty

VIEW PDF

Laminex Compact
Lamintates Warranty

VIEW PDF

Laminex Alfresco Compact
Laminate Warranty

VIEW PDF

For warranty information for more Laminex products, [click here](#).



HETTICH AUSTRALIA

Hettich Australia provides peace of mind to purchasers of major Hettich products with a fully endorsed Lifetime Warranty.

The Lifetime Warranty offers a full replacement guarantee* (view [Hettich website](#) for full warranty terms and conditions) on all Hettich hinges and drawer systems that is supported by the only manufacturer back supplier of cabinet hardware in Australia and New Zealand.

To make a claim, contact Hettich customer service on **1800 687 789** or email support@hettich.com.au where our customer service team will advise on the appropriate course of action, which is at Hettich's discretion, which may include, but is not limited to having the product made available to Hettich to inspect the hardware.



BLUM ARCHITECTURAL HARDWARE

Blum, Inc. (Blum) warrants its lift systems, hinges and/or drawer runners against defects in material and workmanship for as long as the original consumer purchaser owns the products.

Blum will send the original purchaser, without charge, new Blum hardware to replace and defective Blum hardware subject to warranty.

This warranty is a warranty of replacement only. Blum specifically does not warrant removal of the defective hardware nor installation of new hardware. This warranty does not cover hardware that has been incorrectly installed, exposed to excessive loads or otherwise used in any manner contrary to its intended purpose.

For further information, please [click here](#) to refer to the Warranty & Replacement Policy.



CAESARSTONE

Caesarstone products come with a comprehensive 10 Years Limited Warranty. Once your surfaces have been installed, you are encouraged to complete your [Warranty Registration](#) and download [Caesarstone Support and Cleaning Guide](#).

On receipt of your warranty registration information, Caesarstone will provide you with a complimentary cleaning kit and a genuine stainless steel Caesarstone Authenticity Badge which you can attach to your countertop.



CORIAN®

Corian® provides a 10-year proven warranty by Dupont. Please [click here](#) to download Care Brochure and register your warranty.

For further information or assistance with your **Corian®** surface, please call CASF Australia, suppliers of **Corian®** products on 1300 795 044.



DEKTON®

DEKTON® is the only brand that offers a certified warranty in writing.

COSENTINO, S.A.U. guarantees **DEKTON®** by Cosentino products against manufacturing defects for a period of FIFTEEN (15) YEARS as of the date of purchase.

To download Letter of Warranty or to activate warranty of your DEKTON stone, please [click here](#).



OLIVÉRI SINKS & TAPWARE

All Olivéri sinks are provided with a Lifetime Manufacturer's Warranty that complies with the Competition and Consumer Act (2010) in Australia (<http://www.accc.gov.au/>).

This means that your Olivéri sink is warranted to be: of merchantable quality - that is, goods need to reach a basic level of quality given the price of the goods and any description that is provided with the goods, fit for the purpose or job that the consumer described to you or that are self-evident, match any description or sample given to the consumer whether in promotional material, over the phone, in person, on a website or on labelling or packaging, and are free from defects and faults.

Olivéri mixer taps are warranted to be free from manufacturing defects for a period of 10 Years: 5 years only (parts & labour) plus an additional 5 years on the Cartridge (parts only), when used in a domestic situation.

The warranty does not cover against normal wear and may be voided if the product is misused or not installed in accordance with individual installation instructions.

[Click here](#) to read full warranty details.